

# Enjoy steady water temperature, all year long

Thermeau® offers pool heaters with unmatched quality in terms of performance, durability, reliability and eco-friendliness for optimum comfort.



SIGNATURE

## Thermeau®: The comfort you deserve

Invest in comfort all year long with Thermeau®'s SIGNATURE residential heat pump. SIGNATURE has been designed specifically for home owners looking for optimal pool and spa temperatures, regardless of the time of day or year, as well as low energy bills and maintenance costs. SIGNATURE is based on our sophisticated and renowned technology that is used in outdoor residential pools across North America. You'll gain peace of mind knowing that you are getting the very best in performance and reliability.

- Best energy-efficiency performance in the industry
- Next-generation North American components
- Laboratory tests to accurately simulate climatic conditions
- Aesthetic yet resistant finish
- Superior soundproofing for greater discretion
- Quick and easy installation
- Accessible, personalized after-sales service

### UNSURPASSED ENERGY EFFICIENCY

Tested at an ambient temperature of 80°F (27°C), the Thermeau® pool heater generates a coefficient of performance (COP) of up to 6, meaning it produces up to 6 times more energy than it consumes.



2-year warranty  
on labor



7-year warranty  
on parts



10-year limited warranty  
on our heat exchanger

**AHRI CERTIFIED®**  
www.ahridirectory.org

Heat Pump Pool Heaters  
AHRI Standard 1160

### AHRI CERTIFICATION

Internationally recognized AHRI certification guarantees a high-performance, energy-efficient product with low environmental impact.

### INVEST IN LASTING COMFORT

Proud to design products that exceed the highest industry standards, Thermeau® offers a warranty program that ensures your peace of mind.





## Unequalled quality components

S65 - S85 - S105 - S125 - S140B

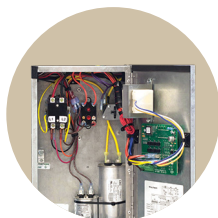

### Auto-diagnostic electronic thermostat

Accurately controls water temperature  
to the chosen degree

For energy savings and comfort

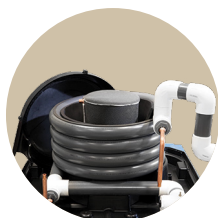

### Triple-action soundproofing

The quietest system available



### Profiled fan blade

Exclusive part improves ventilation  
Significantly reduces noise

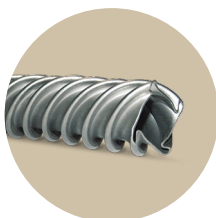

### Twisted titanium tube

Increases exchange surface area  
for better heat transfer  
Resistant to pool and spa chemicals



### Copeland Scroll compressor: The best in the industry

The quietest system on the market

Perfectly suited to all climates  
and environments

Impressive combination of performance  
and energy savings

High-quality, low-maintenance  
components



### Lockable panel

Better screen visibility  
on sunny days

Greater safety and protection  
from the elements



### Direct flow union

Drains water caused by condensation  
No more wet pavement!



# Features

## THERMEAU SIGNATURE SPECIFICATIONS

Specifications	S65	S85	S105	S125	S140B
Volts	230	230	230	230	230
Hertz	60	60	60	60	60
Phase	1	1	1	1	1
Running load amps (RLA)	18.5 A	24.7 A	32.1 A	32.1 A	32.1 A
Locked rotor amps (LRA)	124 A	166 A	148 A	185 A	185 A
Heat exchanger	Titanium / PVC	Titanium / PVC	Titanium / PVC	Titanium / PVC	Titanium / PVC
Fan motor max. load amps	2.4 A	2.4 A	2.4 A	2.4 A	2.4 A
Fan motor HP	1/3	1/3	1/3	1/3	1/3
Fan motor speed (RPM)	825	825	825	825	825
Minimum circuit ampacity (MCA)	25.5 A	30 A	40 A	42.5 A	42.5 A
Maximum overcurrent protection (MOP)	40 A	50 A	70 A	70 A	70 A
Compressor	Copeland Scroll	Copeland Scroll	Copeland Scroll	Copeland Scroll	Copeland Scroll

## THERMEAU SIGNATURE PERFORMANCES

Performances	S65	S85	S105	S125	S140B
80F amb, 80F water, 80% RH	64 000 BTU/h	85 000 BTU/h	105 000 BTU/h	121 000 BTU/h	133 000 BTU/h
COP	6.3	6	6	5.5	6
80F amb, 80F water, 63% RH	60 000 BTU/h	80 000 BTU/h	100 000 BTU/h	116 000 BTU/h	126 000 BTU/h
COP	6.1	5.8	5.8	5.3	5.8
50F amb, 80F water, 63% RH	40 000 BTU/h	58 000 BTU/h	70 000 BTU/h	80 000 BTU/h	87 000 BTU/h
COP	4	4	4	4	4
Cooling	No	No	No	No	No
Defrost	Air	Air	Air	Air	Air
Refrigerant	R-410 A	R-410 A	R-410 A	R-410 A	R-410 A
Minimum water flow (gallons per minute)	20	30	30	40	57
Optimal water flow (gallons per minute)	27	36	45	52	57
Maximum water flow (gallons per minute)	70	70	70	70	70
Maximum water temperature	104 °F	104 °F	104 °F	104 °F	104 °F
Net weight (lbs)	225	230	230	245	265
Shipping weight (lbs)	270	275	275	290	310
Dimensions (in.)	L: 39 W: 33 H: 34	L: 39 W: 33 H: 34	L: 39 W: 33 H: 34	L: 39 W: 33 H: 34	L: 39 W: 33 H: 34
Shipping dimensions (in.)	L: 44 W: 35 H: 39	L: 44 W: 35 H: 39	L: 44 W: 35 H: 39	L: 44 W: 35 H: 39	L: 44 W: 35 H: 39

## MODELS FOR IN-GROUND POOLS

Dimensions (ft.)	Surface (ft. <sup>2</sup> )	Liters	Gallons US	Good	Better	Best
12 X 24	288	45 460	11 900	S65	S65	S65
14 X 28	392	61 323	16 200	S65	S85	S85
15 X 30	450	70 092	18 500	S85	S105	S105
16 X 32	512	79 871	21 100	S105	S105	S125
18 X 36	648	102 285	26 700	S125	S125	S140B
20 X 40	800	124 918	33 000	S140B	S140B	S140B

